

# Empty State



## ES-SCR





Dimensions      OD      76mm  
 Height      217/245\*mm

Hanging Options      ES-SCR-01      4 x Suspension Cables  
 ES-SCR-02      6 x Suspension Cables  
 ES-SCR-03      7 x Suspension Cables  
 ES-SCR-03      8 x Suspension Cables

Hanging Details      Make sure the ceiling is capable of supporting the weight of the light. We recommend you seek the advice of a structural engineer or construction professional.

Fixings not supplied. The appropriate fixing will vary depending on the ceiling substrate, therefore fixings will not be supplied. Please use an appropriate fixing to suit your solution.

Installation should be carried out by a suitably qualified electrician. Access to ceiling void required.

- Metal Finishes
-  White
  -  Black
  -  White / Brass
  -  Black / Brass

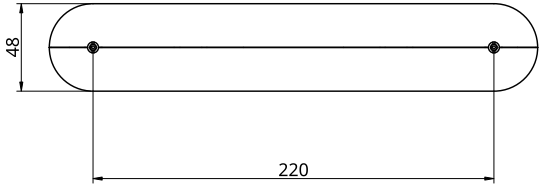
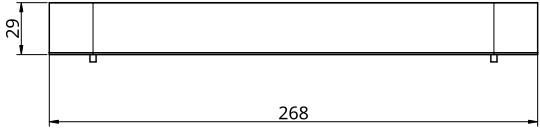
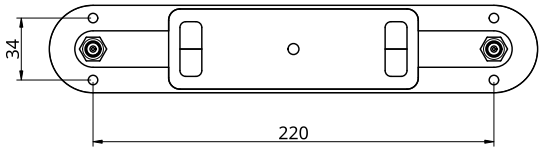

Drawing State: ES-SCR-02  
 For Hanging specific drawings visit [emptystate.com](http://emptystate.com)

# Empty State



## ES-CCR

Dimensions	ES-CCR-01	228 X 48 X 29mm
	ES-CCR-02	268 X 48 X 29mm
	ES-CCR-03	368 X 48 X 29mm



Hanging Options	ES-CCR-01	Suspension Cables
	ES-CCR-02	Suspension Cables
	ES-CCR-03	Suspension Cables

**Hanging Details**

Make sure the ceiling is capable of supporting the weight of the light. We recommend you seek the advice of a structural engineer or construction professional.

Fixings not supplied. The appropriate fixing will vary depending on the ceiling substrate, therefore fixings will not be supplied. Please use an appropriate fixing to suit your solution.

Installation should be carried out by a suitably qualified electrician. Access to ceiling void required.

Metal Finishes		White
		Black
		White / Brass
		Black / Brass

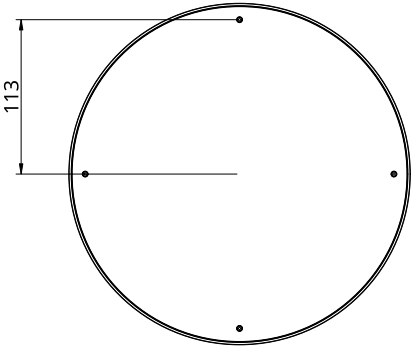
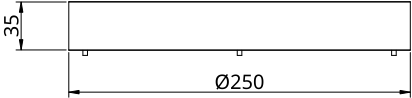
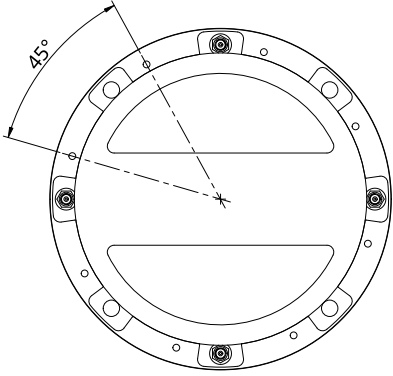

Drawing State: ES-CCR-01  
For Hanging specific drawings visit [emptystate.com](http://emptystate.com)